

DVD-E600

DVD PLAYER

LECTEUR DE DVD



**OWNER'S MANUAL
MODE D'EMPLOI
BEDIENUNGSANLEITUNG
BRUKSANVISNING
MANUALE DI ISTRUZIONI
MANUAL DE INSTRUCCIONES**

Important Note

DK

Advarsel:

Laserrudstråling ved åbning når sikkerhesafbrydere er ude af funktion. Undgå u tsættelse for stråling.

Bemærk:

Netafbryderen STANDBY/ON er sekundært indkoblet og afbryder ikke strømmen fra nette. Den indbyggede netdel er derfor tilsluttet til lysnettet så længe netstikket sidder i stikkontakten.

N

Observer:

Nettbryteren STANDBY/ON er sekundært innkoblet. Den innebygdenetdelen er derfor ikke frakoplet nettet så lenge apparatet er tilsluttet nettkontakten.

S

Klass 1 laserapparat

Varning!

Om apparaten används på annat sätt än i denna bruksanvisning specificerats, kann användaren utsättas för laserstrålning, som översjrunder gränsen för läserklass 1.

Observera!

Strömbrytaren STANDBY/ON är sekundärt kopplad och inte bryter strömmen fråan nätet Den inbyggda nåtdelen är därför ansluten till elnätet så länge stickproppen sitter i v ägguttaget.

SF

Luokan 1 laserlaite + Klass 1 laserapparat

Varoitus!

Laitteen käyttäminen muulla kuin tässä käyttöohjeessa mainitulla tavalla saattaa altistaa käyttäjän turvallisuusluokan 1 ylittävälle lasersäteilille.

Huom.

Toiminnanvalitsin STANDBY/ON on kytketty toisiopuolelle, eikä se kytke laitetta irti sähköverkosta. Sisäänrakennettu verkko-osa on kytkettynä sähköverkkoon aina silloin, kun pistoke on pistorasiassa.

VARO!

AVATTAESSA JA SUOJALUKITUS OHITETTAESSA OLET ALTTIINA NÄKYMÄTTÖMÄLLE LASERSÄTEILYLLE. ÄLÄ KATSO SÄTEESEEN.

WARNING!

OSYNLIG LASERSTRÅLNING NÄR DENNA DEL ÄR ÖPPNAD OCH SPÄRREN ÄR URKOPPLAD. BETRakta EJ STRÅLEN.

Important Note for Users in the UK

Mains plug

This apparatus is fitted with an approved 13 Amp plug. To change a fuse in this type of plug proceed as follows:

- 1 Remove fuse cover and fuse.
- 2 Fix new fuse which should be a BS1362 5 Amp, A.S.T.A. or BSI approved type.
- 3 Refit the fuse cover.

If the fitted plug is not suitable for your socket outlets, it should be cut off and an appropriate plug fitted in its place. If the mains plug contains a fuse, this should have a value of 5 Amp. If a plug without a fuse is used, the fuse at the distribution board should not be greater than 5 Amp.

Note: The severed plug must be disposed of to avoid a possible shock hazard should it be inserted into a 13 Amp socket elsewhere.

How to connect a plug

The wires in the mains lead are coloured with the following code: blue = neutral (N), brown = live (L).

As these colours may not correspond with the colour markings identifying the terminals in your plug, proceed as follows:

- Connect the blue wire to the terminal marked N or coloured black.
- Connect the brown wire to the terminal marked L or coloured red.
- Do not connect either wire to the earth terminal in the plug, marked E (or e) or coloured green (or green and yellow).

Before replacing the plug cover, make certain that the cord grip is clamped over the sheath of the lead - not simply over the two wires.

Copyright in the U.K.

Recording and playback of material may require consent. See Copyright Act 1956 and The Performer's Protection Acts 1958 to 1972.

CAUTION

Use of controls or adjustments or performance of procedures other than those specified herein may result in hazardous radiation exposure.

ATTENTION

L'emploi de commandes, de réglages ou un choix de procédures différents des spécifications de cette brochure peut entraîner une exposition à d'éventuelles radiations pouvant être dangereuses.

ACHTUNG

Die Verwendung von Bedienungselementen oder Einstellungen oder die Durchführung von Bedienungsvorgängen, die nicht in dieser Anleitung aufgeführt sind, kann zu einem Kontakt mit gefährlichen Laserstrahlen führen.

OBSERVERA

Användning av kontroller och justeringar eller genomförande av procedurer andra än de som specificeras i denna bok kan resultera i att du utsätter dig för farlig strålning.

ATTENZIONE

Uso di controlli o regolazioni o procedure non specificamente descritte può causare l'esposizione a radiazioni di livello pericoloso.

PRECAUCIÓN

El uso de los controles o los procedimientos de ajuste o utilización diferentes de los especificados en este manual pueden causar una exposición peligrosa a la radiación.

VOORZICHTIG

Gebruik van bedieningsorganen of instellingen, of uitvoeren van handelingen anders dan staan beschreven in deze handleiding kunnen leiden tot blootstelling aan gevaarlijke stralen.

The unit is not disconnected from the AC power source as long as it is connected to the wall outlet, even if this unit itself is turned off. This state is called the standby mode. In this state, this unit is designed to consume a very small quantity of power.

L'appareil n'est pas isolé de la source d'alimentation aussi longtemps qu'il reste branché sur une prise murale, même lorsqu'il est éteint. Il est alors dit en mode «Veille». Dans ce mode, l'appareil consomme très peu de courant.

Das Gerät ist nicht vom Netz getrennt, solange der Netzstecker noch mit der Wandsteckdose verbunden ist, selbst wenn das Gerät ausgeschaltet wurde. Dieser Betriebszustand wird als Bereitschaftsmodus bezeichnet. In diesem Zustand nimmt das Gerät eine sehr geringe Menge Strom auf.

Enheten är inte urkopplad från nätet så länge som den är ansluten till vägguttaget även om enheten i sig självt är avstängd. Detta kallas för beredskapsläge och i detta tillstånd konsumerar apparaten minimalt med ström.

L'unità non è scollegata dall'impianto elettrico di casa sintanto che rimane collegata ad una presa di corrente anche se è spenta. Questo modo viene chiamato "modo di attesa". In esso, l'unità consuma una quantità molto bassa di energia per mantenere in memoria le impostazioni da voi fatte.

Aunque el propio aparato se encuentre apagado, éste no se desconectará de la fuente de CA siempre que se mantenga enchufado a la toma de corriente. Este estado recibe el nombre de "modo de espera". En este estado, este aparato ha sido diseñado para consumir una cantidad muy pequeña de energía.

De stroomtoevoer naar het toestel is niet afgesloten zolang de stekker nog in het stopcontact zit, zelfs niet als het toestel zelf uitgeschakeld is. Deze toestand wordt "standby" (waak- of paraatstand) genoemd. Het toestel is ontworpen om in deze toestand.

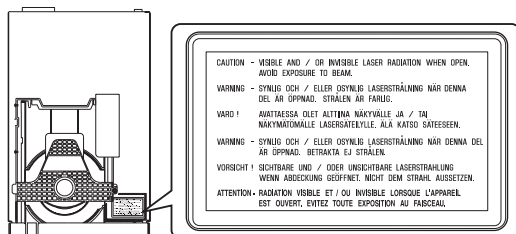
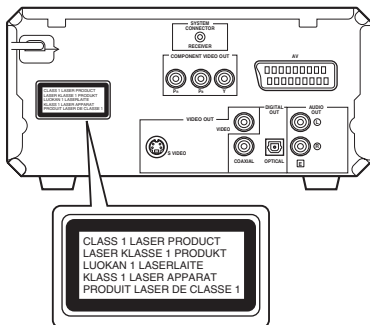

CAUTION VISIBLE AND INVISIBLE LASER RADIATION WHEN OPEN. AVOID EXPOSURE TO BEAM.
ADVARSEL SYNLIG OG OSYNLIG LASERSTRÅLING VED ÅBNING. UNDGÅ UDSÆTTELSE FOR STRÅLING.
ADVARSEL SYNLIG OG OSYNLIG LASERSTRÅLING NÄR DEKSEL ÅPNES. UNNGÅ EKSPONERING FOR STRÅLEN.
VARNING SYNLIG OCH OSYNLIG LASERSTRÅLNING NÄR DENNA DEL ÄR ÖPPNAD. BETRÄKTA EJ STRÅLEN.
VARO! AVATTAESSA OLET ALTTIINA NÄKYVÄLLE JA NÄKYMÄTTÖMÄLLE LASERISÄTEILYLLE. ÄLÄ KATSO SÄTEESEEN.
VORSICHT SICHTBARE UND UNSICHTBARE LASERSTRÄHLUNG WENN ABDECKUNG GEÖFFNET. NICHT DEM STRAHL AUSSETZEN.
DANGER VISIBLE AND INVISIBLE LASER RADIATION WHEN OPEN. AVOID DIRECT EXPOSURE TO BEAM.
ATTENTION RAYONNEMENT LASER VISIBLE ET INVISIBLE EN CAS D'OUVERTURE. EXPOSITION DANGEREUSE AU FAISCEAU.

CAUTION: READ THIS BEFORE OPERATING YOUR UNIT.

- 1 To assure the finest performance, please read this manual carefully. Keep it in a safe place for future reference.
- 2 Install this sound system in a well ventilated, cool, dry, clean place — away from direct sunlight, heat sources, vibration, dust, moisture, or cold. In a cabinet, allow about 2.5cm (1 inch) of free space all around this unit for adequate ventilation.
- 3 Locate this unit away from other electrical appliances, motors, or transformers to avoid humming sounds.
- 4 Do not expose this unit to sudden temperature changes from cold to hot, nor locate this unit in an environment with high humidity (i.e., a room with a humidifier) to prevent condensation inside this unit, which may cause an electrical shock, fire, damage to this unit, and/or personal injury.
- 5 Avoid installing this unit in a location where foreign objects may fall onto this unit or where this unit may be exposed to liquid dripping or splashing. On the top of this unit, do not place:
 - Other components, as they may cause damage and/or discoloration on the surface of this unit.
 - Burning objects (i.e., candles), as they may cause fire, damage to this unit, and/or personal injury.
 - Containers with liquid in them, as they may fall, spilling the liquid and causing an electrical shock to the user and/or damage to this unit.
- 6 Do not cover this unit with a newspaper, tablecloth, curtain, etc. in order not to obstruct heat radiation. If the temperature inside this unit rises, it may cause fire, damage to this unit, and/or personal injury.
- 7 Do not plug in this unit to a wall outlet until all connections are complete.
- 8 Do not operate this unit upside-down. It may overheat, possibly causing damage.
- 9 Do not use excessive force on switches, knobs and/or cords.
- 10 When disconnecting the power cord from the wall outlet, grasp the plug; do not pull the cord.
- 11 Do not clean this unit with chemical solvents; this might damage the finish. Use a clean, dry cloth.
- 12 Use only the voltage specified on this unit. Using this unit with a higher voltage than specified is dangerous and may cause fire, damage to this unit, and/or personal injury. YAMAHA will not be held responsible for any damage resulting from use of this unit with a voltage other than as specified.
- 13 To prevent damage by lightning, disconnect the power cord from the wall outlet during an electrical storm.
- 14 Do not attempt to modify or fix this unit. Contact qualified YAMAHA service personnel when any service is needed. The cabinet should never be opened for any reason.
- 15 When not planning to use this unit for long periods of time (i.e., vacation), disconnect the AC power plug from the wall outlet.
- 16 Be sure to read the “TROUBLESHOOTING” section on common operating errors before concluding that this unit is faulty.
- 17 Before moving this unit, press STANDBY/ON to set the unit in standby mode, then disconnect the AC power plug from the wall outlet.

WARNING

TO REDUCE THE RISK OF FIRE OR ELECTRIC SHOCK, DO NOT EXPOSE THIS UNIT TO RAIN OR MOISTURE.

NOTE:

Pictures shown maybe different between countries. Never make or change connections with the power switched on.

LASER SAFETY

This unit employs a laser. Due to possible eye injury, only a qualified service person should remove the cover or attempt to service this device.

CAUTION

VISIBLE AND INVISIBLE LASER RADIATION WHEN OPEN. AVOID EXPOSURE TO BEAM (WARNING LOCATION: INSIDE ON LASER COVERSHEILD OR THE BACKPLATE OF SET)

LASER

Type	Semiconductor laser GaAlAs
Wave length	650 nm (DVD) 780 nm (VCD/CD)
Output Power	7 mW (DVD) 10 mW (VCD/CD)
Beam divergence	60 degree

DANGER

This unit emits visible laser radiation when open. Avoid direct eye exposure to beam.

When this unit is plugged into a wall outlet, do not place your eyes close to the opening of the disc tray and other openings or look inside.

Introduction

Environmental Information 2
 Supplied accessories 2
 Notes about discs 2
 Cleaning discs 2
 Symbols Used in this Manual 2

Functional Overview

Front and Rear Panels 3
 Remote Control 4

Preparation

General Notes on connections 5
 Digital Connections 5
 Analog Connections 5
 Video Connections 6
 S-Video terminal <A> 6
 Composite Video terminal 6
 Component Video terminal <C> 6
 SCART Connection <D> 6
 Inserting batteries into the Remote Control... 7
 Using the Remote Control 7
 PAL/NTSC Conversion 7
 Turning on the power 7
 Smart Power On/Off 7

Operation

Basic Playback 8
 General Operation 8
 Video control during playback 8
 Audio control during playback 8
 Repeat and Shuffle 9
 Repeat A-B 9
 Disc Resume 9
 OSD (On-Screen Display) 9
 Zoom 10
 Special DVD Features 10
 Playing a Title 10
 Playing a Chapter 10
 Camera Angle 10
 Changing the Audio Language and/or format .. 10
 Subtitles 10
 Special VCD & SVCD Features 10
 Playback Control (PBC) 10
 Preview Function 11

Picture CD & MP3 Playback

General Operation 12
 MP3 & JPEG Navigator 12
 Play Mode 12
 Special JPEG Features 13
 Function Introduction 13
 Preview Function 13
 Zoom picture 13
 Playback with multi-angles 13
 Wipe Effect 13
 Special MP3 Features 13
 Function Introduction 13
 JPEG and MP3 simultaneous playback 13

Setup Menu

Basic Operation 14
 General Setup menu 14
 DISC LOCK 14
 PROGRAM (not for Picture CD/MP3) 14
 OSD LANGUAGE 15
 SCREEN SAVER 15
 Audio Setup menu 15
 SPEAKER SETUP 15
 DIGITAL AUDIO SETUP 16
 EQUALIZER (Sound Mode) 16
 3D (REVERB MODE) 16
 Video Setup menu 17
 TV TYPE 17
 TV DISPLAY 17
 CLOSED CAPTION 18
 COMPONENT 18
 PROGRESSIVE 18
 PICTURE SETTING 19
 PASSWORD SETUP 19
 Preference Setup menu 20
 AUDIO language 20
 SUBTITLE language 20
 DISC MENU language 20
 PARENTAL Control 21
 DEFAULT Setup 21
 MP3/JPEG NAV 21

Troubleshooting 22

Specifications 23

Maintenance 23

Language Code 24

Introduction

Thank you for purchasing this unit. This Owner's Manual explains the basic operation of this unit.

The region code for this set is 2.



Since it is usual for DVD movies to be released at different times in different regions of the world, all players have region codes and discs can have an optional region code. This unit can play discs containing the identical region code, or mentioned as region "ALL". If you load a disc of a different region code to this unit, you will see the region code notice on the screen. The disc will not play, and should be unloaded.

Environmental Information

This unit consists of materials which can be recycled and reused if disassembled by a specialised company. Please observe the local regulations regarding the disposal of packaging materials, exhausted batteries and old equipment.

Supplied accessories

- Remote control
- Batteries (two AA size) for remote control
- Audio pin cable
- Video pin cable
- System control cable (green)
- Owner's Manual

Notes about discs

- This unit is designed for use with DVD video, Video CD, Super video CD, Audio CD, CD-R, CD-RW (MP3 Supported), DVD+RW, DVD+R, DVD-R and DVD-RW.
- CD-R and CD-RW cannot be played unless finalized.
- Some discs cannot be played depending on the recording conditions such as PC environment and application software. The characteristics and condition of the discs; materials, scratches, curvature, and etc, may result in failure.
- Be sure to use only CD-R and CD-RW discs made by reliable manufacturers.
- Do not use any non standard shaped discs (heart, etc.)
- Do not use disc with tape, scals, or paste on it, damage to the unit may result.
- Do not use a disc printed on its surface by a commercially available label printer.

Cleaning discs

- When a disc becomes dirty, clean it with a cleaning cloth. Wipe the disc from the centre out. Do not wipe in a circular motion.
- Do not use solvents such as benzine, thinner, commercially available cleaners, or antistatic spray intended for analog records.

Symbols Used in this Manual

The below symbols appear in some headings and notes with the following meanings:

	- Description refers to playback of DVD-video discs
	- Description refers to playback of Video CDs
	- Description refers to playback of Audio CDs
	- Description refers to playback of Super VCDs

- Some DVD video discs require specific functions or allow only limited functions during playback.
- " × " may appears on the TV screen which means that the function is not available on that specific DVD video disc.

Manufactured under license from Dolby Laboratories. "Dolby" and the double-D symbol are trademarks of Dolby Laboratories.

This product incorporates copyright protection technology that is protected by method claims of certain U.S. patents and other intellectual property rights owned by Macrovision Corporation and other rights owners. Use of this copyright protection technology must be authorized by Macrovision Corporation, and is intended for home and other limited viewing uses only unless otherwise authorized by Macrovision Corporation. Reverse engineering or disassembly is prohibited.

Front and Rear Panels

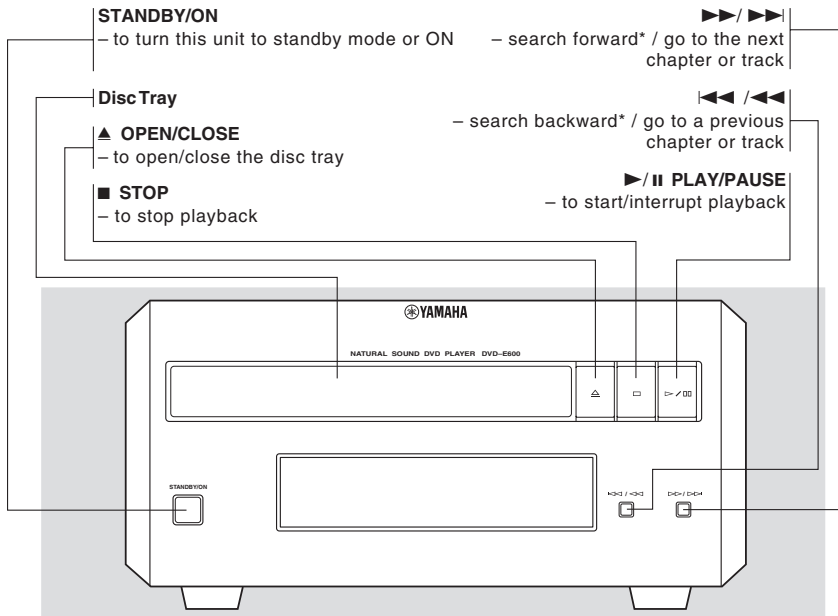

* Press button for about two seconds.

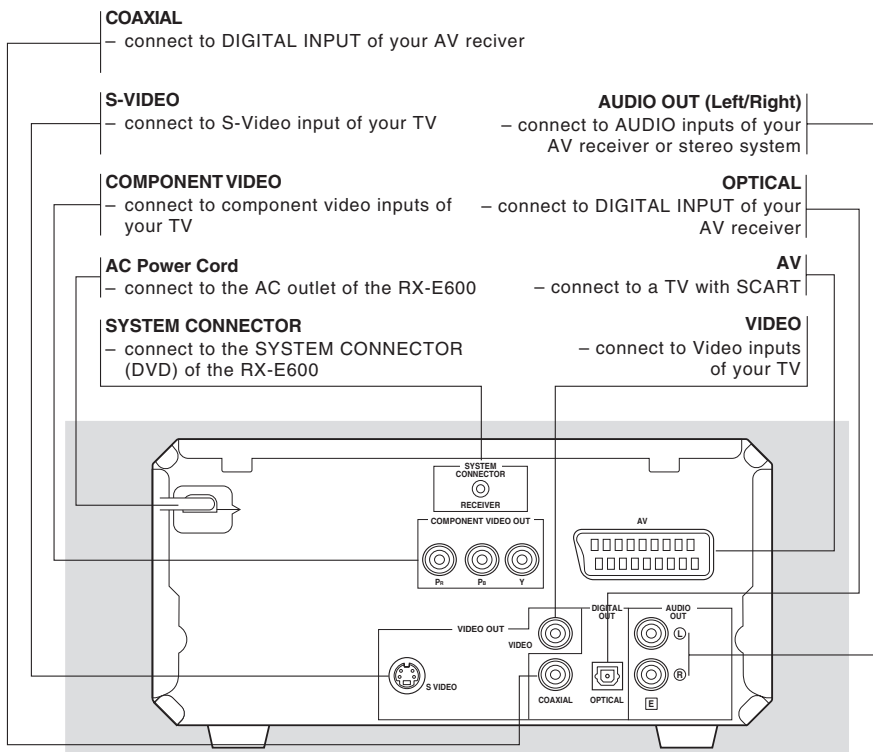

Caution: Do not touch the inner pins of the jacks on the rear panel. Electrostatic discharge may cause permanent damage to the unit.

Functional Overview

Remote Control

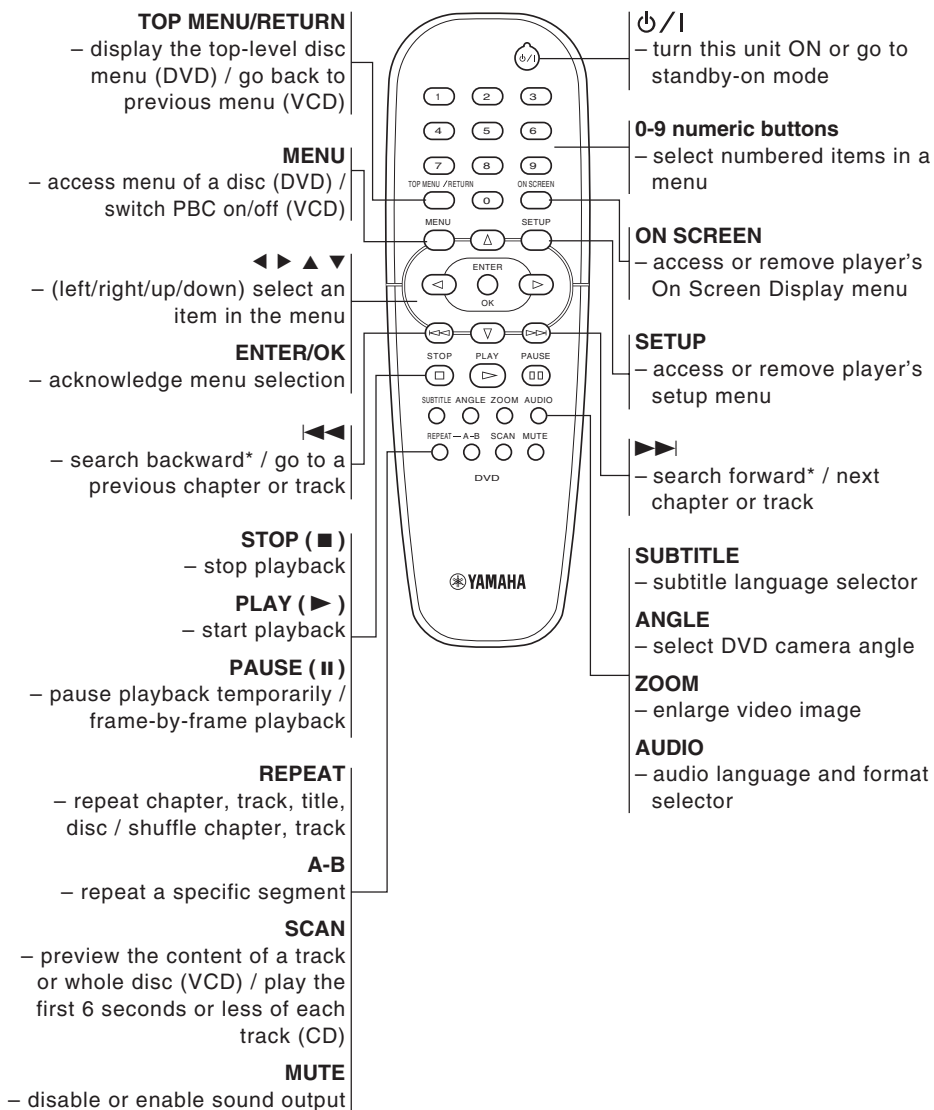

* Press and hold button for about two seconds.

Please refer to the RX-E600 manual for instructions on connecting this unit to the RX-E600 receiver.

General Notes on connections

Never make or change connections with the power switched on.

- Depending on the equipment you wish to connect, there are various ways you could connect this unit. Possible connections are shown in the following drawings.
- Please refer to the manuals of other equipment as necessary to make the best connections.
- Do not connect this unit via your VCR. The video quality could be distorted by the copy protection system.
- Do not connect this unit's audio out jack to the phono in jack of your audio system.

Digital Connections

This unit has COAXIAL and OPTICAL digital out jacks. Connect one or both of them to your AV receiver equipped with Dolby digital or MPEG decoder using each specific cable (separate purchase).

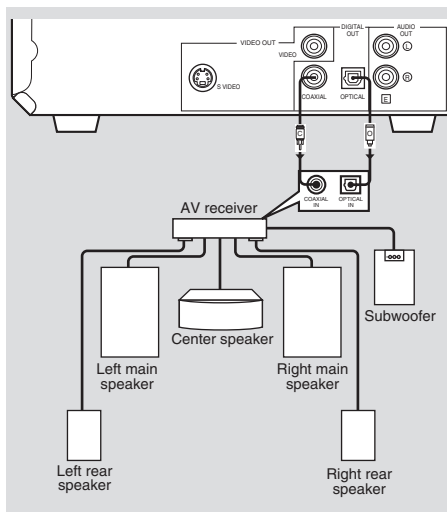

You will need to set this unit's digital output to All (see 'DIGITAL OUTPUT').

Note:

– If the audio format of the digital output does not match the capabilities of your receiver, the receiver will produce a strong, distorted sound or no sound at all. Make sure to select the appropriate audio format at menu screen included on the disc.

Pressing AUDIO once or more may change not only audio languages but also audio formats, and the selected format appears for several seconds on the status window.

Analog Connections

Use audio/video cable supplied with this unit to connect AUDIO OUT L (left) and R (right) jacks of this unit to corresponding input jacks of your audio equipment such as Stereo amplifier.

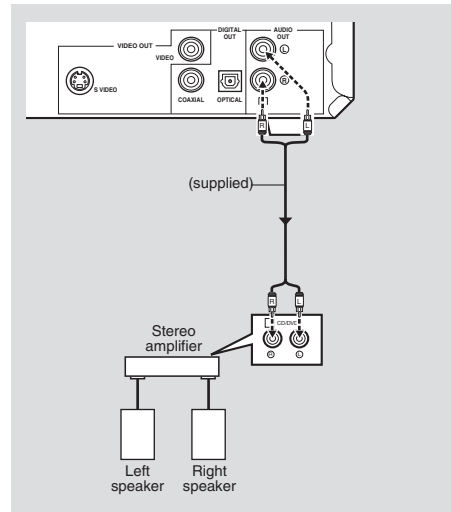

Preparation

Video Connections

The player has three types of video output jacks. Use one of them in accordance with the input jacks of the equipment to be connected.

Note:

– If your AV receiver has video output jacks, connect your receiver (and then to your TV) so that you can use one TV for several different video sources (LD, VCR etc.) by simply switching the input source selector of your receiver.

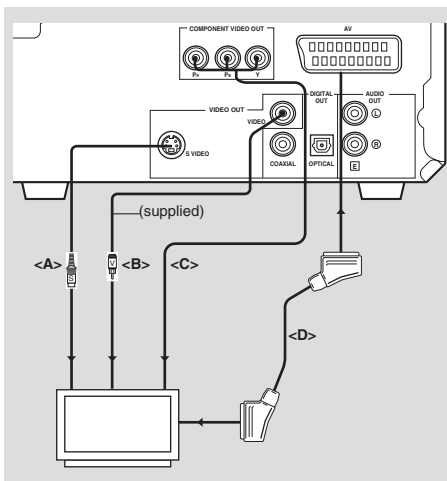

S-Video terminal <A>

S (separate) video connection achieves a clearer picture than composite video connection by separating color and luminance when transmitting signals. Use commercially available S-video cable.

Composite Video terminal

Use audio/video cable supplied with this unit when connecting the player to a TV.

Component Video terminal <C>

Component video connection achieves high fidelity in reproducing colors (better performance than S-video connection), separating video signal into luminance (Y, terminal color-coded as green), and color difference (Pb, blue/Pr, red). Use commercially available coaxial cables. Receiver (and TV) with component input is required. Observe the color of each jack when connecting.

SCART Connection <D>

Use a SCART cable to connect this unit's AV terminal to a SCART terminal on your TV.

Note:

– Ensure that the "TV" indication on SCART cable is connected to the TV set and "DVD" indication on SCART cable is connected to this unit.

Inserting batteries into the Remote Control

- 1 Open the battery cover by pressing in the tab, then lift off the cover.
- 2 Insert batteries with the correct polarity as indicated by the + and - symbols inside the battery compartment.
- 3 Close the cover.

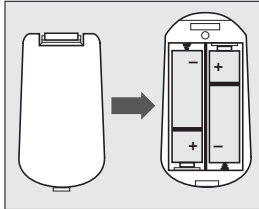

CAUTION!

- Remove batteries if they are exhausted or not to be used for a long time.
- Do not use old and new or different types of batteries in combination.
- Batteries contain chemical substances, so they should be disposed off properly and kept away from children.

Using the Remote Control

- Direct the remote control at the remote sensor of the DVD player.
- Do not drop or give the remote control a shock.
- Do not leave the remote control in extremely hot or humid places.
- Do not spill water or put anything wet on the remote control.

PAL/NTSC Conversion

This player is equipped with a PAL/NTSC conversion feature to convert the video output of the disc to match your TV system. The conversions supported are as below. To activate the conversion, refer to "TV TYPE":

Disc		Output format		
Type	Format	Selected mode		
		PAL	NTSC	MULTI
DVD	PAL	PAL	NTSC	PAL
	NTSC	PAL	NTSC	NTSC
VCD	PAL	PAL	NTSC	PAL
	NTSC	PAL	NTSC	NTSC

Notes:

- "MULTI" can only be selected when using a TV that has both the PAL and NTSC systems.
- Slight picture distortions may occur due to this conversion. This is normal. Thus, the "MULTI" is most suitable for the best picture quality.

Turning on the power

- 1 Connect the AC power cord to the power outlet.
- 2 Turn on the TV and your receiver.
- 3 Select the appropriate input source at the receiver that was used to connect to this unit. Refer to the equipment owner's manual for detail.
- 4 Turn this unit on.
- 5 Set the TV to the correct Video IN channel. (eg. EXT1, EXT2, AV1, AV2, AUDIO/VIDEO, etc. (Refer to your TV owner's manual for detail))
 - The front display lights up and the default screen appears on the TV.

Smart Power On/Off

When in STOP mode, the DVD player will switch to standby mode after 15 minutes without any operations for saving energy. It is easily reactivated by pressing the POWER or PLAY on the remote control or the STANDBY/ON button on the front panel.

Basic Playback

- 1 Press STANDBY/ON on the front panel to turn on the DVD player.
- 2 Press ▲ (OPEN/CLOSE) on the front panel to open disc loading tray.
- 3 Place the chosen disc in the tray, with the label facing up.
- 4 Press ▲ (OPEN/CLOSE) again to close the tray.
 - After recognizing this disc, the player begin to playback automatically.
 - If you press PLAY when the tray is open, this unit closes the tray and starts playback.

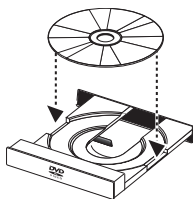

Notes:

- DVDs may have a region code. Your player will not play discs that have a region code different from the region code of your player.
- If 'DISC LOCK' is set to LOCK and the disc inserted is not authorized, the 6-digit code must be entered and/or the disc must be authorized (see 'DISC LOCK').

General Operation

Note: All instructions set out below refer to the remote control, unless otherwise stated.

Video control during playback

STOP

- 1 You can resume the play from the point at which you stopped last time, if you just press STOP once. It will start from the beginning if you press STOP twice to stop playback.

PAUSE/STEP

- 1 To get a still picture, press PAUSE during playback.
- 2 To step forward to the next frame picture, press PAUSE again.
 - It resumes to the normal playback for CD.
- 3 To resume normal playback, press PLAY.

SKIP

- 1 Press ◀◀ or ▶▶ briefly during playback to go to the next chapter/track or to return to the beginning of the current chapter/track respectively.
- 2 Press ◀◀ twice briefly to step back to the previous chapter/track.
- 3 To go directly to any chapter/track, enter the chapter/track number using the numeric buttons and press ENTER/OK.

Note: Long press of the ◀◀ or ▶▶ till switch on backward or forward search.

SEARCH

- 1 To search the contents in fast speed, press ▶ or ◀ for fast forward/backward searching.
- 2 Press ▶ or ◀ again to increase the speed for searching.
- 3 Press PLAY to return to normal playback.

Slow Motion

- 1 To get a slow motion effect during playback, press ▲ or ▼.
- 2 Press ▲ or ▼ again, you can get different playback forward/backward speeds.
- 3 Press PLAY to return to normal play back.

- 1 To get a slow motion effect during playback, press ▼.
- 2 Press ▼ again, you can get different playback forward speeds.
- 3 Press PLAY to return to normal play back.

Note: The SLOW BACKWARD function is not available for VCD/Super VCD discs.

Audio control during playback

MUTE

- 1 Press MUTE to disable the sound output.
- 2 Press MUTE again to deactivate the mute.

Audio channel selection

- 1 Super VCD has two stereo audio channels which are used for playing karaoke or the audio language selection. (for instance, you can choose one channel for only the music background of the song while you play the karaoke.)
- 2 Press AUDIO to select the audio channels you want.
- 3 VCD has only one stereo audio channel, you can select STEREO, MONO LEFT, MONO RIGHT or MIX-MONO by pressing AUDIO.
 - STEREO: Output the left and right audio channels of the disc through the left and right audio jacks accordingly.
 - MONO LEFT: Output the left audio channels of the disc through the left and right audio jacks.
 - MONO RIGHT: Output the right audio channels of the disc through the left and right audio jacks.
 - MIX-MONO: each of the audio jacks can output the same audio effect as stereo.

Repeat and Shuffle



- Each time you press REPEAT, the Repeat/Shuffle mode changes as follows;

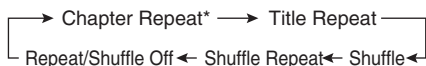

* This feature may not be available with some discs.



With PBC OFF,

- Each time you press REPEAT, the Repeat/Shuffle mode changes as follows;

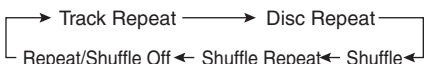

Repeat A-B

DVD-Video Discs: repeat a sequence in a title
Video and Audio CDs: repeat a sequence in a track

- 1 Press Repeat A-B at your chosen starting point.
- 2 Press Repeat A-B again at your chosen end point.
→ The repeat sequence begins.
- 3 To exit the sequence, press Repeat A-B.

Disc Resume

This player can resume playback of the last 5 discs, even if the disc was ejected or the power switched off.

- 1 Load one disc, which is one of the last 5 discs.
- 2 Press PLAY when DVD player is recognizing the disc. If the information of this disc has been stored in the memory of DVD player, it will be played back from the stop point last time.

OSD (On-Screen Display)

This function will provide some information about your playing disc and a rough transferring speed of the video data on the screen.

- Press ON SCREEN.
The Status window appears on the TV.

Title/Chapter/Track selection

- 1 Press ▲▼ to select "TITLE" or "CHAPTER" (DVD) or "TRACK" (VCD).
- 2 Press ENTER/OK.
- 3 Select a title, chapter or track number using the numeric buttons.

Time Search

- 1 Press ▲▼ to select "TT TIME" or "CH TIME"(DVD) or "TRACK TIME" or "DISC TIME"(VCD).
→ "TT TIME" refers to the total time of the current title, and the "CH TIME" refers to the total time of the current chapter.
- 2 Press ENTER/OK.
- 3 Enter hours, minutes and seconds from left to right using the numeric buttons. (e.g. 0:34:27)

Audio/Subtitle/Angle

You can change "AUDIO", "SUBTITLE" or "ANGLE" if available on the disc you are playing.

- 1 Press ▲▼ to select "AUDIO", "SUBTITLE" or "ANGLE".
- 2 Press ENTER/OK.
- 3 For Audio and Subtitle,
Press ▲▼ to highlight your selection and press ENTER/OK.

or

For Angle,
Select an angle using the numeric buttons.

Repeat/Time Display

- 1 Press ▲▼ to select "REPEAT" or "TIME DISP.".
- 2 Press ENTER/OK.
- 3 Press ▲▼ to highlight your selection and press ENTER/OK.

Time display

Each time you press ON SCREEN, the time display changes as follows;

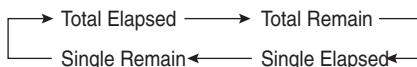

Zoom

The Zoom function allows you to change the image size.

- 1 Press ZOOM to activate the function.
 - Use ▲▼◀▶ to view other parts of the zoomed picture.
 - Playback will continue.
 - Zoom function is also effective when the playback is paused.
- 2 Press ZOOM repeatedly to return to the original size.

Special DVD Features

Playing a Title

A DVD disc may have one or more titles. This depends on the content (a movie, video clips, a drama series, etc.) on the disc.

- After you load a disc, information about the content shows on the screen waiting for your selection. You can also press TOP MENU to turn back to the title menu during playback.
 - Press the appropriate numeric buttons or ▲▼◀▶ to highlight your selection.
 - Press ENTER/OK to confirm.

Playing a Chapter

When you have selected a title, it may include one or more chapters.

- Any time you want to watch another chapter during playback, press MENU to turn back to the chapter menu (If disc has chapter menu).
 - Press the appropriate numeric buttons or ▲▼◀▶ on the remote control to highlight your selection.
 - Press ENTER/OK.
 - After a chapter has been selected, you also can press ◀◀ or ▶▶ to make a change.

Camera Angle

Some discs contain scenes which have been shot simultaneously from various angles.

This DVD player allows you to select the desired camera angle.

- Press ANGLE on your remote control.
Note: The function is available only for the DVD discs which have several angles recorded.

Changing the Audio Language and/or format

- Press AUDIO repeatedly to select the different languages.

Note: The function will be activated only if the DVD is recorded with multi-language audio tracks.

Subtitles

- Press SUBTITLE repeatedly to select the different subtitles.

Note: The function will be activated, only if the DVD or Super VCD is recorded with multi-subtitles.

Special VCD & SVCD Features

Playback Control (PBC)

PBC function allows you to enter the index menu which is used to select a track after loading the VCD & SVCD disc. If you want to activate the function during the playback or after pressing STOP twice,

- 1 Press MENU to set the PBC On.
 - Pay attention to the hint on the screen.
- 2 Use ◀◀ or ▶▶ to select the page you like.
 - If the items of the index menus are numbered, press the appropriate numeric buttons.
 - Press ENTER/OK.
- 3 Press RETURN to enter the index menu during the playback.

Notes:

- The content of the index menu depends on the disc. Please refer to the disc's instructions for details.
- If the disc doesn't include the PBC information, this function will have no effect.

If you want to skip the index menu and playback directly from the beginning,

- 1 Press MENU to switch off the function.

Preview Function

- Press SCAN to enter previewing menu.
- Press ▲▼ to highlight "TRACK DIGEST", "DISC INTERVAL" or "TRACK INTERVAL".
- Press ENTER/OK to open one option.



- After you enter the menu of any digest type,
 - To quit preview function: Press ▲▼◀▶ to highlight EXIT and press ENTER/OK.
 - To return to the previewing menu for selecting the other digest type: Press ▲▼◀▶ to highlight MENU and press ENTER/OK.

Note: You can select "TRACK INTERVAL" only during playback, with PBC Off.

1 TRACK DIGEST

This function will minimize the picture of every track in order to display every six of these tracks on the screen to help you know the content of every track on the disc.



- To choose the desired track, press ▲▼◀▶ to highlight the second line and input your selected track number next to "SELECT".
 - Select the others from the current six by pressing the ◀◀ or ▶▶ to open the previous or next page and press ENTER/OK.
- You can also select a track by highlighting the preview screen using ▲▼◀▶ and pressing ENTER/OK.

2 DISC INTERVAL

This function is used to divide a disc into six parts by regular intervals and display them on one page to help you preview the whole disc.



- To choose the desired track, press ▲▼◀▶ to highlight the second line and input your numerical selection next to "SELECT" and press ENTER/OK.
- You can also select a track by highlighting the preview screen using ▲▼◀▶ and pressing ENTER/OK.

3 TRACK INTERVAL

This function is used to divide a single track into six parts by regular intervals and display them on one page to help you preview the selected track.



- To choose the desired track, please press ▲▼◀▶ to highlight the second line and input your numerical selection next to "SELECT" and press ENTER/OK.
- You can also select a track by highlighting the preview screen using ▲▼◀▶ and pressing ENTER/OK.

Picture CD & MP3 Playback

This player can playback JPEG format pictures and MP3 files on a personally recorded CD-R/RW disc or commercial CD, and is compatible with Kodak Picture CD. This player does not support PROGRESSIVE JPEG.

- Playback pictures or songs one by one automatically.
- Album and track selection.
- Repeat (disc / album / track / picture).
- Select any music or pictures from the disc to playback them together.
- Maximum numbers of files in one folder are 500.
- Maximum number of folders in one layer are 500.
- Maximum nested directory is eight levels.
- Maximum 13 characters are supported.
- The file names, MP3, JPG, JPE, and JPEG, are supported.
- Maximum files Programmable is 100.

General Operation

- If you choose WITH MENU in the Setup Menu (Please refer to the MP3 & JPEG navigator below), the Picture CD/MP3 CD menu will be shown on the screen before playback.

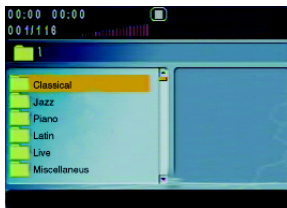

- At any time during JPEG playback, press MENU to return to the menu.
- To open the selected folder, press ENTER/OK.
- The menu shows six files or folders at a time. To move to the next (or previous) page, press ►► (or ◄◄).
- You cannot record the MP3 audio output from digital audio output jacks.

MP3 & JPEG Navigator

To select a different playback method, follow the steps below.

- 1 At STOP mode, press SETUP to open the setup menu.
- 2 Press ◄► to highlight PREFERENCE icon.
- 3 Press ▼ to open the PREFERENCE menu.
- 4 Press ▲▼ to highlight the MP3/JPEG NAV menu.
- 5 Press ► to enter the menu.
- 6 Press ▲▼ to highlight the WITHOUT MENU or WITH MENU item.
 - WITHOUT MENU: automatically playback all files in according date sequence (MP3 only).
 - WITH MENU: playback files in the selected folder.
- 7 Press ENTER/OK to confirm your selection.

Play Mode

Auto Playback

If you choose WITHOUT MENU, the DVD player will automatically play MP3 CD in sequence when it is loaded.

Repeat / Shuffle

- When the Picture CD/MP3 CD menu is shown on the screen, Press REPEAT repeatedly, the button beside PLAY MODE will display different option,
 - Repeat One: One file will be replayed time after time.
 - Repeat Folder: All files in this folder will be replayed time after time.
 - Shuffle: All files in this folder will be played at random without any repeat.
 - Folder: All files in this folder will be played.
- If you press REPEAT during playback, the option will be displayed on the screen accordingly.
- During Shuffle mode, you can skip tracks by pressing ◄◄ or ►►.

Special JPEG Features

Function Introduction

Picture CD is a disc with a collection of JPEG format pictures, and all extension filenames should end with '.JPG'. The CD can be recorded on any computer, and pictures may be from digital camera or scanner. If the customers prefer, they can make this CD become a Digital Album.

You can choose any general function introduced in General Operation, besides, you also can,

- Display the thumbnails of 12 pictures.
- Zoom the picture.
- Rotate the picture.
- Flip the picture vertically or horizontally.
- Scan pictures by different effects.

Preview Function

This function shows the content of the current folder or the whole disc.

- 1 Press STOP during playback of JPEG pictures. You will see the thumbnails of 12 pictures on the screen.



- 2 Press ◀◀ or ▶▶ to display the other pictures on the next or the previous page.
- 3 Press ▲▼◀▶ to highlight one of them and press ENTER/OK to playback, or, Move the cursor to highlight  on the bottom of the page to start playback from the first picture on the current page.
- 4 Press MENU to go to the Picture CD/MP3 CD menu.

Zoom picture

- During playback or pause, press ZOOM to display the picture with different scales.
- Press ▲▼◀▶ to view the rest of the zoomed picture.

Playback with multi-angles

When displaying one picture on TV screen

- Press ▲▼◀▶ to get different effects.
 - ▲: Flip the picture vertically.
 - ▼: Flip the picture horizontally.
 - ◀: rotate the picture anti-clockwise.
 - ▶: rotate the picture clockwise.

Wipe Effect

- Press ANGLE repeatedly to choose different wipe effects.

Special MP3 Features

Function Introduction

"MP3" stands for "MPEG Audio Layer-3". and is a part of the MPEG standard. A CD can store up to 10 hours of MP3 audio, which is nearly 10 times as much as an Audio CD. Each song is recorded as a file. You can choose any general function introduced in General Operation. You can also choose different playback speeds.

JPEG and MP3 simultaneous playback

- 1 Firstly playback MP3 music according to the instructions introduced in playback Selection.
- 2 Then select a picture to playback. Refer to the instructions introduced in playback Selection.
 - Now the pictures will be played back in sequence together with MP3 music.
- 3 To quit simultaneous playback, press MENU to return to the Picture CD/MP3 CD menu, then pictures will be stopped. After that, press STOP, then MP3 music will be stopped as well.

Note: In the function of JPEG and MP3 Simultaneous Playback, ◀◀ and ▶▶ are invalid for MP3.

Setup Menu

Basic Operation

- 1 Press SETUP in the STOP mode to enter the Setup Menu.
- 2 Press ENTER/OK to go to the next level submenu or confirm your selection.
- 3 Press ◀▶ to enter the submenu or return to the previous menu.
- 4 Press ▲▼ to highlight the desired menu.
- 5 Press SETUP to quit the setup menu.
→ When you quit the setup menu, the settings will be stored in the player's memory even if the player is switched to power off.

General Setup menu

Some settings need to be made in this menu. They are: "DISC LOCK", "PROGRAM", "OSD LANGUAGE" and "SCREEN SAVER".

Follow the steps below:

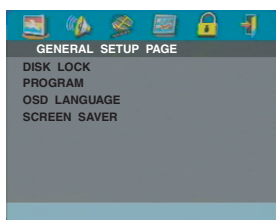

- 1 Press SETUP to enter the setup menu.
- 2 Press ◀▶ to choose the GENERAL SETUP icon .

DISC LOCK

When the disc is locked, the player will store its specific code into the memory for future identification. For the next playback, the DVD player will prompt you to enter the password. Then, press ENTER/OK to load the disc.

- 1 Press ▲▼ to highlight "DISC LOCK".
- 2 Enter its submenu by pressing ▶.
→ Lock: Lock the disc being played.
→ Unlock: unlock the disc.
- 3 Press ◀ to return to the General Setup Page.

PROGRAM (not for Picture CD/MP3)

- 1 press ▲▼ to choose "PROGRAM".
- 2 Press ▶ to move the cursor to the field of the submenu to choose the item Input menu.
→ Input menu: Enter the Program item.
- 3 Press ENTER/OK to enter the program page.



Input your favorite track

- 1 Input valid track number by pressing the numeric buttons.
- 2 Press ▲▼◀▶ to move the cursor to the next selected position.
→ If the track number is more than ten, press ▶▶ to open the next page and go on programming, or press ▲▼◀▶ to highlight NEXT button, and then press ENTER/OK.
- 3 Repeat this steps to input another track number until the whole program is completed.

Remove a track

- 1 Press ▲▼◀▶ to move the cursor to the track you want to remove.
- 2 Press ENTER/OK or PLAY to remove this track from the program menu.

Playback tracks

When programming is completed,

- 1 Press ▲▼◀▶ to move the cursor to the START button.
- 2 Press ENTER/OK.
→ DVD player will playback the selected tracks under the programmed sequence.

Quit the program playback

In the Program menu,

- 1 Press ▲▼◀▶ to move the cursor to the EXIT button.
- 2 Press ENTER/OK to quit this menu.

Stop the program playback

- During playback of the programmed tracks, press STOP once. Then after you press PLAY, the DVD player will start resume-playback.
- Press STOP twice to cancel the resume-function.

Repeat the program playback

- During playback of the programmed tracks, press REPEAT. The programmed tracks can be played again.

Note: If you select Shuffle mode by pressing REPEAT several times, the DVD player cancels program playback.

OSD LANGUAGE

This option is to select a language for information displayed on TV screen.

- 1 Press ▲▼ to highlight "OSD LANGUAGE" in the General Setup menu.
- 2 Enter its submenu by pressing ►.
- 3 Move the cursor by pressing ▲▼ to highlight the selected language.
- 4 Press ENTER/OK to confirm.
- 5 Press ◀ to return to the General Setup Page.

SCREEN SAVER

This function is used to turn the screen saver on or off.

- 1 Press ▲▼ to highlight "SCREEN SAVER" in the General Setup menu.
- 2 Enter its submenu by pressing ►.
- 3 Move the cursor by pressing ▲▼ to highlight the selected item.
 - On: In STOP or No DISC mode, if no actions are performed within 5~6 minutes, the screen saver will be activated.
 - Off: Screen saver is disabled.
- 4 Press ENTER/OK.
- 5 Press ◀ to return to the General Setup Page.

Audio Setup menu

There are items included in Audio Setup Page such as "SPEAKER SETUP", "DIGITAL AUDIO SETUP", "EQUALIZER" and "3D".

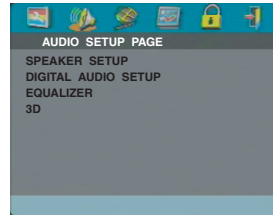

- 1 Press SETUP to enter the setup menu.
- 2 Press ◀► to choose the AUDIO SETUP icon .

SPEAKER SETUP

This menu contains setup options for your analog audio output, such as "DOWNMIX", "DRC" (Dynamic Range Compression) etc. which makes the setup system reproduce high quality surround sound.

DOWNMIX

- 1 Press ▲▼ to highlight the "DOWNMIX".
- 2 Enter its submenu by pressing ►.
- 3 Move the cursor by pressing ▲▼ to highlight the selected item.
 - LT/RT
 - This option should be used only if your DVD player is connected to a Dolby Prologic decoder.
 - STEREO
 - This option will downmix Dolby Digital signals directly into analogue stereo from L/R jacks.
 - VIRTUAL SURROUND
 - This option will reproduce the surround channels virtually.
- 4 Press ENTER/OK.
- 5 Press ◀ to return to the Audio Setup Page.

DRC (Dynamic Range Compression)

The DVD player will compress the dynamic range of its sound output for late-night listening.

- 1 Press ▲▼ to highlight "DRC".
- 2 Enter its submenu by pressing ►.
- 3 Move the cursor by pressing ▲▼ to highlight the selected item.
 - ON: Enable DRC.
 - OFF: Disable DRC.
- 4 Press ENTER/OK.
- 5 Press ◀ to return to the Audio Setup Page.

DIGITAL AUDIO SETUP

In this menu, you can set up the digital audio output signal from the digital jacks, such as coaxial etc.

DIGITAL OUTPUT

- 1 Press ▲▼ to highlight DIGITAL OUTPUT.
- 2 Enter its submenu by pressing ►.
- 3 Press ▲▼ to highlight the selected item.
 - All: Original digital signals output.
 - PCM Only: If your receiver is PCM-compatible, or your receiver can not decode MPEG-2 or Dolby Digital, choose this option.
- 4 Press ENTER/OK.
- 5 Press ◀ and return to the Audio Setup Page.

Note: If DIGITAL OUTPUT is set to "ALL", all audio settings except MUTE are invalid.

LPCM OUTPUT

In this menu, you can select PCM digital output between 48kHz and 96kHz.

- 1 Press ▲▼ to highlight the "LPCM OUTPUT".
- 2 Enter its submenu by pressing ►.
- 3 Move the cursor by pressing ▲▼ to highlight the selected item.
 - 48K: 96kHz (if available on disc) PCM data stream will be converted to 48kHz.
 - 96K: If the 96kHz disc is copy protected, the digital output will be muted to comply with the standards.
- 4 Press ENTER/OK.
- 5 Press ◀ to return to the Audio Setup Page.

EQUALIZER (Sound Mode)

The "EQUALIZER" allows you to select from various preset modes that control the frequency bands of sound to optimize certain musical styles.

It greatly enhances the excitement and enjoyment of your favourite music.

- 1 Press ▲▼ to highlight the "EQUALIZER".
- 2 Enter its submenu "SOUND MODE" by pressing ►.
- 3 Press ►.
- 4 Move the cursor by pressing ▲▼ to highlight the selected item.
 - NONE: Play the disc under the original sound effect.
- 5 Press ENTER/OK.
- 6 Press ◀ to return to the Audio Setup Page.

Note: The sound may be distorted if the selected sound mode is incompatible with the disc contents.

In that case, select another sound mode or "NONE".

3D (REVERB MODE)

The "3D" can simulate the echoes and frequency response of some particular places so as to make you feel like personally on the place. The choices are OFF, CONCERT, LIVING ROOM, HALL, ARENA, and CHURCH.

- 1 Press ▲▼ to highlight the "3D".
- 2 Enter its submenu "REVERB MODE" by pressing ►.
- 3 Press ►.
- 4 Move the cursor by pressing ▲▼ to highlight the selected item.
 - OFF: Play the disc under the original sound effect.
- 5 Press ENTER/OK.
- 6 Press ◀ to return to the Audio Setup Page.

Video Setup menu

There are items included in Video Setup menu such as "TV TYPE", "TV DISPLAY", "CLOSED CAPTION", "COMPONENT", "PROGRESSIVE" and "PICTURE SETTING".

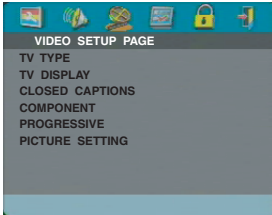

- 1 Press SETUP to enter the setup menu.
- 2 Press ◀▶ to choose the VIDEO SETUP icon .

TV TYPE

Before viewing the DVD or VCD, ensure that the PAL or NTSC setting of the system matches your TV set.

- 1 Press ▲▼ to highlight "TV TYPE" in the Video Setup menu.
- 2 Enter its submenu by pressing ▶.
- 3 Move the cursor by pressing ▲▼ to highlight one option.
- 4 Press ENTER/OK.
- 5 Press ◀ to return to the Video Setup Page.

Note: Choosing "NTSC" item indicates that the player will output NTSC signals, Similarly, you can get PAL signals by choosing the "PAL" option. The option "MULTI" means video output depends on the format of the DVD or VCD discs.

TV DISPLAY

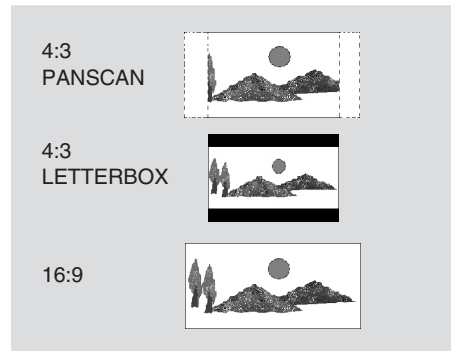

Select the aspect ratio of the TV to be connected.

4:3 PANSKAN → when you connect a normal TV to the DVD player. Displays the wide picture on the whole TV screen with a portion automatically cut off.

4:3 LETTERBOX → when you connect a normal TV to the DVD player. Displays a wide picture with bands displayed on the upper and lower portions of the TV screen.

16:9 → when you connect a wide-screen TV to the DVD player.

Setup the item as follows,

- 1 Press ▲▼ to highlight the "TV DISPLAY" option in the Video Setup menu.
- 2 Enter its submenu by pressing ▶.
- 3 Move the cursor by pressing ▲▼ to highlight the selected item.
- 4 Press ENTER/OK.
- 5 Press ◀ to return to the Video Setup Page.

Setup Menu

CLOSED CAPTION

Closed Captions are data that are hidden in the video signal on specific discs, invisible without a special decoder. The difference between subtitles and captions is that subtitles are intended for hearing persons and captions are for the hearing impaired. Subtitles rarely show all of the audio. For example, captions show sound effects (e.g., "phone ringing" and "footsteps"), while subtitles don't.

Before you select this function, please ensure that the disc contains closed captions information and your TV set also has this function.

- 1 Press ▲▼ to highlight "CLOSED CAPTION" in the Video Setup menu.
- 2 Enter its submenu by pressing ►.
- 3 Move the cursor by pressing ▲▼ to highlight one option.
→ ON: Enable Closed Caption.
→ OFF: Disable Closed Caption.
- 4 Press ENTER/OK.
- 5 Press ◀ to return to the Video Setup Page.

COMPONENT

In this menu, you can select whether to output YUV signals from the COMPONENT jacks or to output RGB signals from the AV jack (SCART).

- 1 Press ▲▼ to highlight "COMPONENT".
- 2 Enter its submenu by pressing ►.
- 3 Move the cursor by pressing ▲▼ to highlight one option.
→ YUV: Output YUV signals from the COMPONENT jacks.
→ RGB: Output RGB signals from the AV jack (SCART).
- 4 Press ENTER/OK.
- 5 Press ◀ to return to the Video Setup Page.

PROGRESSIVE

This player's COMPONENT video jack can output progressive signals to a progressive signal compatible TV for an extra high-quality picture.

- 1 Press ▲▼ to highlight "PROGRESSIVE".
- 2 Enter its submenu by pressing ►.
- 3 Move the cursor by pressing ▲▼ to highlight one option.
→ ON: Enable Progressive.
→ OFF: Disable Progressive.
If you select "ON", the player prompts you to confirm your selection.
- 4 Press ENTER/OK.
- 5 Press ◀ to return to the Video Setup Page.

Notes on activating Progressive:

- Ensure that your TV has progressive scan.
 - Connect with YPbPr video cable.
 - When the Progressive is active, the VIDEO (CVBS) and S VIDEO jacks do not output video signals.
 - If there is no picture, wait 15 seconds for auto recover or deactivate Progressive manually.
- 1 Open the disc tray by pressing ▲ (OPEN/CLOSE) on the front panel.
 - 2 Press ◀.
 - 3 Press MUTE.
- You cannot activate Progressive when "COMPONENT" is set to "RGB".

CONSUMERS SHOULD NOTE THAT NOT ALL HIGH DEFINITION TELEVISION SETS ARE FULLY COMPATIBLE WITH THIS PRODUCT AND MAY CAUSE ARTIFACTS TO BE DISPLAYED IN THE PICTURE. IN CASE OF 525 OR 625 PROGRESSIVE SCAN PICTURE PROBLEMS, IT IS RECOMMENDED THAT THE USER SWITCH THE CONNECTION TO THE "STANDARD DEFINITION" OUTPUT. IF THERE ARE QUESTIONS REGARDING OUR VIDEO MONITOR COMPATIBILITY WITH THIS MODEL 525P AND 625P DVD PLAYER, PLEASE CONTACT OUR CUSTOMER SERVICE CENTER.

This unit is compatible with the complete line of YAMAHA products, including the projectors DPX-1000, LPX-510 and the plasma monitor PDM-4210E.

PICTURE SETTING

In this menu, you can personalize your picture color by adjusting brightness, contrast, tint and color (saturation).

- 1 Press ▲▼ to highlight "PICTURE SETTING" in the Video Setup menu.
- 2 Press ► to open its submenu.

BRIGHTNESS

- 1 Press ▲▼ to highlight "BRIGHTNESS".
- 2 Press ► to open the level bar.

BRIGHTNESS |||||..... -1

- 3 Press ◀▶ to increase and decrease the brightness level.
- 4 Press ENTER/OK to return to the PICTURE SETTING menu.

CONTRAST

- 1 Press ▲▼ to highlight "CONTRAST".
- 2 Press ► to open the level bar.
- 3 Press ◀▶ to increase and decrease the contrast level.
- 4 Press ENTER/OK to return to the PICTURE SETTING menu.

TINT

- 1 Press ▲▼ to highlight "TINT".
- 2 Press ► to open the level bar.
- 3 Press ◀▶ to increase and decrease the tint level.
- 4 Press ENTER/OK to return to the PICTURE SETTING menu.

COLOR (saturation)

- 1 Press ▲▼ to highlight "COLOR".
- 2 Press ► to open the level bar.
- 3 Press ◀▶ to increase and decrease the color level.
- 4 Press ENTER/OK to return to the PICTURE SETTING menu.

PASSWORD SETUP

This item is used for the parental control and disc lock. Enter your six digit password when a hint is displayed on the screen.

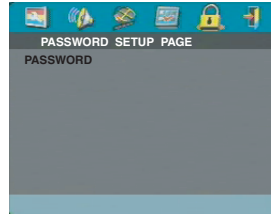

- 1 Press SETUP to enter the setup menu.
- 2 Press ◀▶ to choose the PASSWORD icon .
- 3 Press ▼ to highlight "PASSWORD".
- 4 Press ► to highlight "CHANGE".
- 5 Press ENTER/OK to open the Password Change Page.

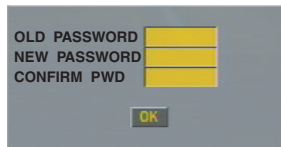

- 6 Press ▼ to repeatedly until the player prompt you to enter the old password.
- 7 Enter the current 6 digit code.
- 8 If successful, the player will prompt for a new one.
- 9 After that, enter the new password again to reconfirm.
- 10 Press ENTER/OK to return to the Password Setup Page.

Notes:

- You can change the setup of parental control and load a locked disc with a valid password being entered.
- If you forget your password, you can enter the default password 842100, then you can input your password after logging on.

Preference Setup menu

There are options included in this menu such as "AUDIO", "SUBTITLE", "DISC MENU", "PARENTAL", "DEFAULT" and "MP3/JPEG NAV".

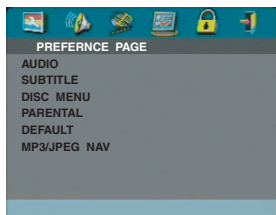

- 1 Press STOP twice.
- 2 Press SETUP to enter the setup menu.
- 3 Press ◀▶ to choose the PREFERENCE icon .

AUDIO language

DVD discs are available with multiple audio languages. Use this option to select the preferred default audio language.

- 1 Press ▲▼ to highlight "AUDIO".
- 2 Enter the submenu by pressing ▶.
- 3 Move the cursor by pressing ▲▼ to highlight the selected option.
→ If you want to choose other languages, please refer to the instructions on the next page.
- 4 Press ENTER/OK.
- 5 Press ◀ to return to the Preference Page.

Note: Your DVD disc may not include the audio language which you set in the AUDIO menu. If so, the player will use another audio language instead.

SUBTITLE language

DVD discs are available with multi-subtitle languages. Use this option to select the preferred default subtitle language.

- 1 Press ▲▼ to highlight "SUBTITLE".
- 2 Enter the submenu by pressing ▶.
- 3 Move the cursor by pressing ▲▼ to highlight the selected option.
→ If you want to choose other languages, please refer to the following instructions.
- 4 Press ENTER/OK.
- 5 Press ◀ to return to the Preference Page.

Note: Your DVD disc may not include the subtitle which you set in the SUBTITLE menu. If so, the player will use another subtitle language instead.

DISC MENU language

DVD discs are available with multiple disc menu languages. This option is used to select the default disc menu language.

- 1 Press ▲▼ to highlight "DISC MENU".
- 2 Enter the submenu by pressing ▶.
- 3 Move the cursor by pressing ▲▼ to highlight the selected item.
→ If you want to choose other languages, please refer to the following instructions.
- 4 Press ENTER/OK.
- 5 Press ◀ to return to the Preference Page.

Note: If your DVD disc doesn't include the DISC MENU language you have set, the player will use another recorded language instead.

If you choose "OTHERS" in AUDIO, SUBTITLE or DISC MENU menu,

You can select other languages. Please do as follows,

- 1 Move the cursor by pressing ▲▼ to highlight "OTHERS".
- 2 Press ENTER/OK.
→ The DVD player will prompt you to enter a language code (Four digits).
- 3 Input a language code by pressing numeric buttons.
→ Please look up the preferred language code in the chapter LANGUAGE CODE, which can be found at the end of this manual.
- 4 Press ENTER/OK.

PARENTAL Control

Movies on DVDs may contain scenes which are not suitable for children. Therefore, discs may contain 'Parental Control' information which applies to the complete disc or to certain scenes on the disc. These scenes are rated from 1 to 8, and alternative, more suitable scenes are available on the disc. Ratings are country dependent. The 'Parental Control' feature allows you to prevent discs from being played by your children or to have certain discs played with alternative scenes.

- VCD, SVCD, CD have no level indication, so parental control function has no effect on those kinds of discs. This applies to most illegal DVD discs.
- You can follow the steps below to setup the parental control:
 - 1 Press ▲▼ to highlight "PARENTAL".
 - 2 Move to its submenu by pressing ►.
 - 3 Then use ▲▼ to highlight a rating for the disc inserted.
 - 4 Press ENTER/OK to confirm, then press ◀ to return to the Preference Page.

No Parental Control

Parental Control is not activated. The Disc will be played in full.

- 1 Select 8 ADULT item.
- 2 Press ENTER/OK.

Ratings 1 to 7:

- 3 Some discs contain scenes which are not suitable for children. All scenes with a rating higher than you set will be skipped during playback. However if the disc contains alternate scenes, these will play automatically. If not, the playback will stop and the six digits code will need to be entered again.

DEFAULT Setup

If problems occur while setting up the DVD player, the "DEFAULT" function can be used to reset all options to the factory defaults and all your personal settings will be erased.

- 1 Press ▲▼ to highlight "DEFAULT".
- 2 Highlight RESET by pressing ►.
- 3 Press ENTER/OK.

Note: When this function is activated, all setups will be reset to factory defaults.

MP3/JPEG NAV

This menu allows you to select alternate settings when you playback picture CD and MP3 CD.

- 1 Press ▲▼ to highlight MP3/JPEG NAV.
- 2 Press ► to enter the submenu.
- 3 Press ▲▼ to highlight WITHOUT MENU or WITH MENU.
 - WITHOUT MENU: playback all pictures or MP3 music in sequence automatically.
 - WITH MENU: playback pictures or MP3 music in the selected folder.
- 4 Press ENTER/OK to confirm your selection.

Troubleshooting

Refer to the chart below when this unit does not function properly. If the problem you are experiencing is not listed below or if the instruction below does not help, set this unit to the standby mode, disconnect the power cord, and contact the nearest authorized YAMAHA dealer or service center.

Problem	Solution
No power	<ul style="list-style-type: none"> – Check if the AC power cord is properly connected.
No picture	<ul style="list-style-type: none"> – Check if the TV is switched on. – Check the video connection. – If you did not use Progressive Scan connections (using the Y PB PR jacks on the DVD Player) and you do not have a picture at the TV, please follow the steps below to turn off Progressive Scan; <ol style="list-style-type: none"> 1. Press ▲ (OPEN/CLOSE) to open the disc tray. 2. Press ◀. 3. Then press MUTE to deactivate the Progressive. The DVD Player will reset itself to Component/Interlaced video.
Distorted picture	<ul style="list-style-type: none"> – The disc is badly scratched or dirty. – Sometimes a small amount of picture distortion may appear. This is not a malfunction.
Completely distorted picture or black/white picture with DVD or Video CD	<ul style="list-style-type: none"> – Make sure the PAL/NTSC setting at the DVD player matches the video signal of your television. (See PAL/NTSC CONVERSION)
No sound or distorted sound	<ul style="list-style-type: none"> – Adjust the volume. – Check that the speakers are connected correctly.
No audio at digital output	<ul style="list-style-type: none"> – Check the digital connections. – Check if your receiver can decode MPEG-2 and if not, please make sure the digital output is set to PCM. – Check if the audio format of the selected audio language matches your receiver capabilities.
Disc can't be played	<ul style="list-style-type: none"> – The DVD+R/DVD+RW/DVD-R/DVD-RW/CD-R/CD-RW must be finalized. – Ensure the disc label is facing up. – Check if the disc is defective by trying another disc. – If you have recorded this particular Picture CD or MP3 CD yourself, please ensure that your disc contains at least about 6~10 pictures or 3~5MP3 music tracks before using it with the player.
No return to start-up screen when disc is removed	<ul style="list-style-type: none"> – Reset the unit by switching the player off, then on again.
The player does not respond to the remote control	<ul style="list-style-type: none"> – Aim the remote control directly at the sensor on the front of the player. – Reduce the distance to the player. – Replace the batteries in the remote control. – Insert the batteries with their polarities (+/- signs) as indicated.
Buttons do not work	<ul style="list-style-type: none"> – In order to completely reset the player, unplug the AC cord from the AC outlet.
Player does not respond to some operating commands during playback	<ul style="list-style-type: none"> – Operations may not be permitted by the disc. Refer to the instructions of the disc.
DVD Video player cannot read CDs/DVDs	<ul style="list-style-type: none"> – Use a commonly available cleaning CD/DVD to clean the lens before sending the DVD Video player for repair.
Cannot record MP3	<ul style="list-style-type: none"> – SCMS copy protected discs cannot be recorded digitally. Try recording by analog jacks.

PLAYBACK SYSTEM

DVD Video
 Video CD & SVCD
 CD
 PICTURE CD
 CD-R, CD-RW
 DVD+R, DVD+RW
 DVD-R, DVD-RW

VIDEO PERFORMANCE

Video (CVBS) Output 1 Vpp into 75 ohm
 S-Video output Y: 1 Vpp into 75 ohm
 C: 0.286 Vpp into 75 ohm
 (U.S.A., Canada and Korea models)
 0.3 Vpp into 75 ohm (Other models)
 RGB (SCART) output 0.7 Vpp into 75 ohm
 Component video output Y: 1 Vpp into 75 ohm
 Pb/Cb Pr/Cr: 0.7 Vpp into 75 ohm

AUDIO FORMAT

Digital	Mpeg/ Dolby Digital PCM	Compressed Digital 16, 20, 24 bits fs, 44.1, 48, 96 kHz
	MP3(ISO 9660)	24, 32, 56, 64, 96, 128, 256 kbps fs, 16, 22.05, 24, 32, 44.1, 48 kHz

Analog Sound Stereo

Specifications subject to change without prior notice.

AUDIO PERFORMANCE

DA Converter	24 bit	
Signal-Noise (1 kHz)	105 dB	
Dynamic range (1 kHz)	100 dB	
DVD	fs 96 kHz	2 Hz- 44 kHz
	fs 48 kHz	2 Hz- 22 kHz
SVCD	fs 48 kHz	2 Hz- 22 kHz
	fs 44.1 kHz	2 Hz- 20 kHz
CD/VCD	fs 44.1 kHz	2 Hz- 20 kHz
Distortion and Noise (1 kHz)	0.003%	

TV STANDARD (PAL/50 Hz) (NTSC/60 Hz)

Number of lines	625	525
Playback	Multistandard	(PAL/NTSC)

CONNECTIONS

SCART	Euroconnector
Y Output	Cinch (green)
Pb/Cb Output	Cinch (blue)
Pr/Cr Output	Cinch (red)
S-Video Output	Mini DIN, 4 pins
Video Output	Cinch
Audio Output (L+R)	Cinch
Digital Output	1 coaxial, 1 optical
	IEC958 for CDDA / LPCM/ MPEG1
	IEC1937 for MPEG 2 and Dolby Digital

CABINET

Dimensions (W x H x D)	217 x 108 x 346 mm
Weight	Approx. 2.5 Kg

POWER SUPPLY

Power inlet	230 V, 50 Hz
Power usage	Approx. 12 W
Power usage standby	< 1 W

Maintenance

Cleaning the Cabinet

- Use a soft cloth slightly moistened with a mild detergent solution. Do not use a solution containing alcohol, spirits, ammonia or abrasives.

Cleaning Discs

- When a disc becomes dirty, clean it with a cleaning cloth. Wipe the disc from the center out. Do not wipe in a circular motion.
- Do not use solvents such as benzine, thinner, commercially available cleaners, or antistatic spray intended for analog records.

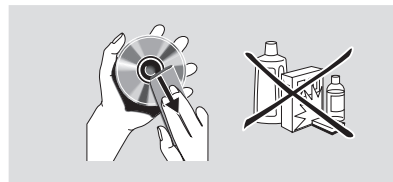

Language Code

These pages can be used to select other languages. This does not affect the options in “AUDIO”, “SUBTITLE” or “DISC MENU”.

Abkhazian	6566	German	6869
Afar	6565	Gikuyu; Kikuyu	7573
Afrikaans	6570	Greek,	6976
Albanian	8381	Guarani	7178
Amharic	6577	Gujarati	7185
Arabic	6582	Hausa	7265
Armenian	7289	Hebrew	7269
Assamese	6583	Herero	7290
Avestan	6569	Hindi	7273
Aymara	6589	Hiri Motu	7279
Azerbaijani	6590	Hungarian	7285
Bashkir	6665	Icelandic	7383
Basque	6985	Ido	7379
Belarusian	6669	Indonesian	7368
Bengali	6678	Interlingua (International)	7365
Bihari	6672	Interlingue	7369
Bislama	6673	Inuktitut	7385
Bokmål, Norwegian	7866	Inupiaq	7375
Bosnian	6683	Irish	7165
Breton	6682	Italian	7384
Bulgarian	6671	Japanese	7465
Burmese	7789	Javanese	7486
Castilian, Spanish	6983	Kalaallisut	7576
Catalan	6765	Kannada	7578
Chamorro	6772	Kashmiri	7583
Chechen	6769	Kazakh	7575
Chewa; Chichewa; Nyanja	7889	Khmer	7577
Chichewa; Chewa; Nyanja	7889	Kikuyu; Gikuyu	7573
Chinese	9072	Kinyarwanda	8287
Chuang; Zhuang	9065	Kirghiz	7589
Church Slavic; Slavonic;	6785	Komi	7586
Church Slavonic; Church	6785	Korean	7579
Chuvash	6786	Kuanyama; Kwanyama	7574
Cornish	7587	Kurdish	7585
Corsican	6779	Kwanyama; Kuanyama	7574
Croatian	7282	Lao	7679
Czech	6783	Latin	7665
Danish	6865	Latvian	7686
Dutch	7876	Letzeburgesch;	7666
Dzongkha	6890	Limburgan; Limburger;	7673
English	6978	Limburger; Limburgan;	7673
Esperanto	6979	Limburgish; Limburger;	7673
Estonian	6984	Lingala	7678
Faroese	7079	Lithuanian	7684
Fijian	7074	Luxembourgish;	7666
Finnish	7073	Macedonian	7775
French	7082	Malagasy	7771
Frisian	7089	Malay	7783
Gaelic; Scottish Gaelic	7168	Malayalam	7776
Gallegan	7176	Maltese	7784
Georgian	7565	Manx	7186

These pages can be used to select other languages. This does not affect the options in “AUDIO”, “SUBTITLE” or “DISC MENU”.

Maori	7773	Sotho, Southern	8384
Marathi	7782	South Ndebele	7882
Marshallese	7772	Spanish; Castilian	6983
Moldavian	7779	Sundanese	8385
Mongolian	7778	Swahili	8387
Nauru	7865	Swati	8383
Navaho, Navajo	7886	Swedish	8386
Navajo; Navaho	7886	Tagalog	8476
Ndebele, North	7868	Tahitian	8489
Ndebele, South	7882	Tajik	8471
Ndonga	7871	Tamil	8465
Nepali	7869	Tatar	8484
Northern Sami	8369	Telugu	8469
North Ndebele	7868	Thai	8472
Norwegian	7879	Tibetan	6679
Norwegian Bokmål; Bokmål,	7866	Tigrinya	8473
Norwegian Nynorsk;	7878	Tonga (Tonga Islands)	8479
Nyanja; Chichewa; Chewa	7889	Tsonga	8483
Nynorsk, Norwegian;	7878	Tswana	8478
Occitan (post 1500); Proven	7967	Turkish	8482
Old Bulgarian; Old Slavonic;	6785	Turkmen	8475
Old Church Slavonic; Old	6785	Twi	8487
Old Slavonic; Church	6785	Uighur	8571
Oriya	7982	Ukrainian	8575
Oromo	7977	Urdu	8582
Ossetian; Ossetic	7983	Uzbek	8590
Ossetic; Ossetian	7983	Vietnamese	8673
Pali	8073	Volapük	8679
Panjabi	8065	Walloon	8765
Persian	7065	Welsh	6789
Polish	8076	Wolof	8779
Portuguese	8084	Xhosa	8872
Provençal; Occitan (post)	7967	Yiddish	8973
Pushto	8083	Yoruba	8979
Quechua	8185	Zhuang; Chuang	9065
Raeto-Romance	8277	Zulu	9085
Romanian	8279		
Rundi	8278		
Russian	8285		
Samoan	8377		
Sango	8371		
Sanskrit	8365		
Sardinian	8367		
Scottish Gaelic; Gaelic	7168		
Serbian	8382		
Shona	8378		
Sindhi	8368		
Sinhalese	8373		
Slovak	8375		
Slovenian	8376		
Somali	8379		



©2004 YAMAHA CORPORATION All rights reserved.

YAMAHA ELECTRONICS CORPORATION, USA 6660 ORANGETHORPE AVE., BUENA PARK, CALIF. 90620, U.S.A.
YAMAHA CANADA MUSIC LTD. 135 MILNER AVE., SCARBOROUGH, ONTARIO M1S 3R1, CANADA
YAMAHA ELECTRONIK EUROPA G.m.b.H. SIEMENSSTR. 22-34, 25462 RELLINGEN BEI HAMBURG, F.R. OF GERMANY
YAMAHA ELECTRONIQUE FRANCE S.A. RUE AMBROISE CROIZAT BP70 CROISSY-BEAUBOURG 77312 MARNE-LA-VALLEE CEDEX02, FRANCE
YAMAHA ELECTRONICS (UK) LTD. YAMAHA HOUSE, 200 RICKMANSWORTH ROAD WATFORD, HERTS WD18 7GQ, ENGLAND
YAMAHA SCANDINAVIA A.B. J A WETTERGRENS GATA 1, BOX 30053, 400 43 VÄSTRA FRÖLUNDA, SWEDEN
YAMAHA MUSIC AUSTRALIA PTY, LTD. 17-33 MARKET ST., SOUTH MELBOURNE, 3205 VIC., AUSTRALIA

YAMAHA CORPORATION
Printed in Malaysia  WD90090